

NOTES:
 INSULATOR MATERIAL:POLYESTER UL94V-0
 CONTACT MATERIAL:BRASS
 CURRENT RATING:2A
 CONTACT RESISTANCE:≤20MΩ/CONTACT
 INSULATION RESISRACE:≥1000MΩ AT V=100V
 WITHSTANDING VOLTAGE:1000V AC/MINUTE
 OPERAING TEMPERATURE:-25℃ TO +85℃

PART NO:1037-M02MXX01

2Pin

G0:Gold Flash
 S0:Gold Flash/Tin
 SN:TIN

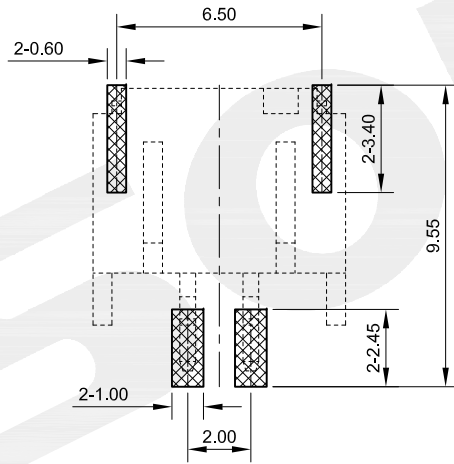
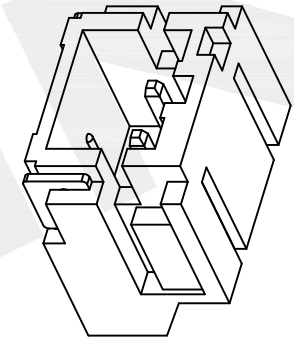
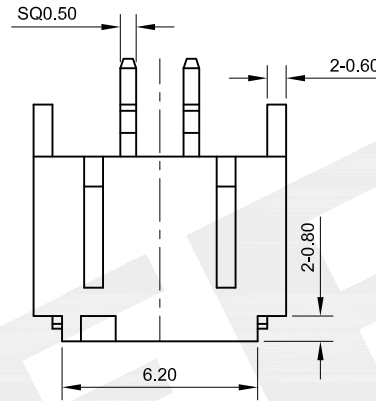

PCB LAYOUT

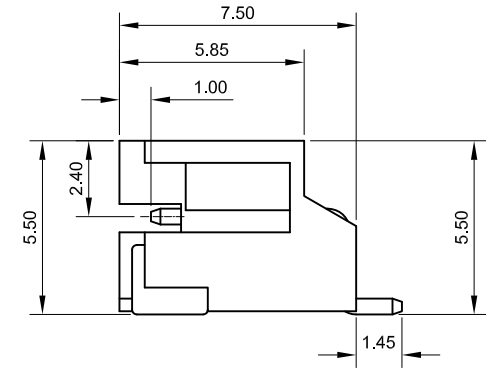
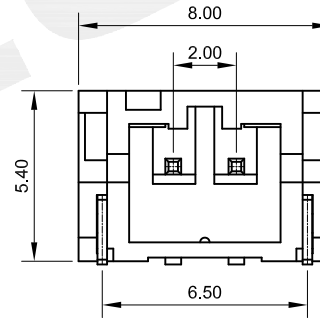

					OPERATION	DRAW	Loong	2018/11/08	SCALE	FIT	SOLEPIN 东莞市硕品电子有限公司 DONGGUAN SOLEPIN ELECTRONICS CO., LTD. Specializing in the production of connectors and wiring harness products. HTTP://WWW.SOLEPIN.COM E-MAIL:SALES@SOLEPIN.COM TEL:0769-83003805 FAX:0769-83003036	
					X.X	±0.40			UNIT	mm		
					X.XX	±0.25			SIZE	A4		
					X.XXX	±0.15			SHEET	1/1		
A/1	2018/11/08	NEW	Loong	Andy	Angle	±3°			PROJ.	⊕	PART NO.	1037-M02MXX01
REV	DATE	MODIFICATION DESCRIPTION	CHANGE	APPROVE	DIM	TOL	APPROVE	Andy			TITLE:	PH2.0mm Connector
											DWG.No.	