

客户图

NOTES:

1.FINISH:

- 1.1 HOUSING: LCP BLACK 94V-0
- 1.2 CONTACT: H-HIGH CONDUCTIVE BRASS, GOLD (SEE P/N) PLATED IN CONTACT AREA, GOLD FLASH PLATED IN SOLDER AREA, 50μ"MIN NICKEL UNDERPLATED OVERALL.

2. ELECTRICAL:

- 2.1 CURRENT RATING: 14A AC. DC
- 2.2 DIELECTRIC WITHSTANDING VOLTAGE: 1800V,AC/Minute
- 2.3 CONTACT RESISTANCE: 10mΩ MAX.
- 2.4 INSULATION RESISTANCE: 1000 mΩ Min
- 2.5 Operation Temperature: -40°C to +125°C
- 2.6 VOLTAGE RATING: 400V AC/DC;

3.SALT SPRAY TEST:

- 3.1 CONCENTRATION IS 5%, THE TEMPERATURE IS 35±2°C, TEST TIME 24H MIN, NO OXIDATION OR RUST

4.Max Processing Temp:265°C Seconds 40S

5.ORDER INFORMATION:

3500-S XXX SN 112 E X X

Pin数 端子电镀: 塑胶高度: A=A KEY
 002=1*02PIN SN=Tin 112=11.20mm B=B KEY
 ~ 012=1*12PIN

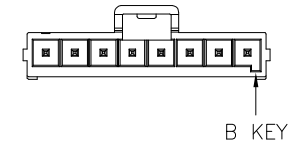
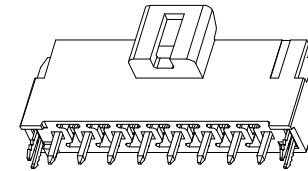
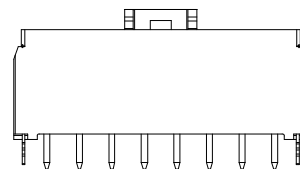
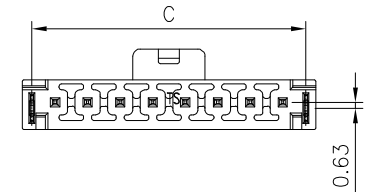
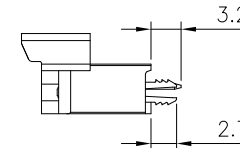
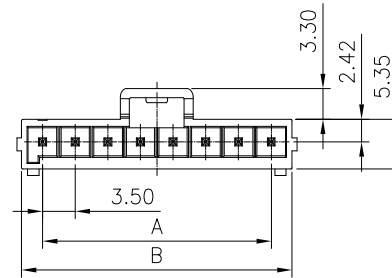
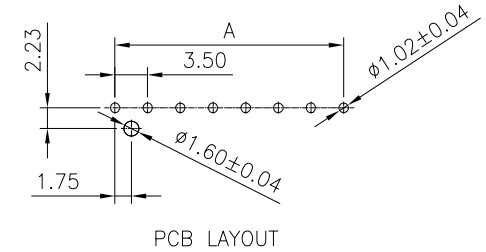
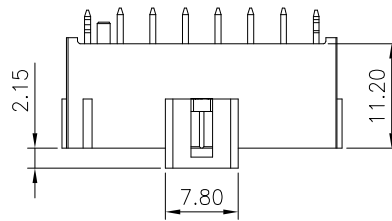

Foles	Dimensions(mm)		
	A	B	C
02	3.50	10.60	8.50
03	7.00	14.10	12.00
04	10.50	17.60	15.50
05	14.00	21.10	19.00
06	17.50	24.60	22.50
07	21.00	28.10	26.00
08	24.50	31.60	29.50
12	38.50	45.60	43.50

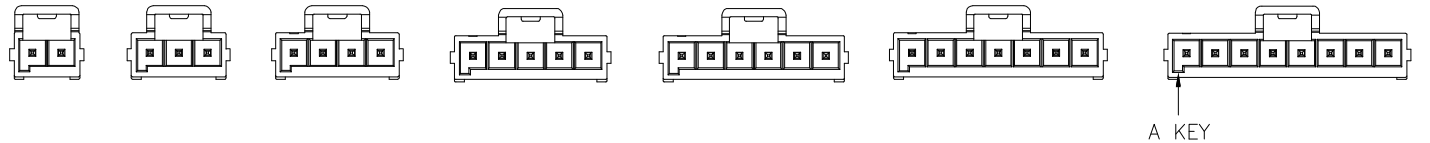

REV	DATE	MODIFICATION DESCRIPTION	CHANGE	APPROVE	OPERATION	DRAW	WLY	SCALE	SOLEPIN 东莞市硕品电子有限公司 Professional connector manufacturer DONGGUAN SOLEPIN ELECTRONICS CO., LTD.			
AO		NEW			X.X ±0.40	DESIGN	Jensen	1:1	SIZE	A4	PART NO.	3500-SXXXSX112EXX
					X.XX ±0.25	CHECK	Jack		SHEET	1/1	TITLE:	3.50mm CRIMP STYLE CONNECTORS
					X.XXX ±0.15	APPROVE	Andy		PROJ.	☯	DRAW NO.	SP-706
					Angle ±3°							
					DIM. TOL	UNIT	mm	SCALE				

客户图

NOTES:

1.FINISH:

- 1.1 HOUSING: LCP BLACK 94V-0
- 1.2 CONTACT: H-HIGH CONDUCTIVE BRASS, GOLD (SEE P/N) PLATED IN CONTACT AREA, GOLD FLASH PLATED IN SOLDER AREA, 50u"MIN NICKEL UNDERPLATED OVERALL.

2. ELECTRICAL:

- 2.1 CURRENT RATING: 14A AC. DC
- 2.2 DIELECTRIC WITHSTANDING VOLTAGE: 1800V,AC/Minute
- 2.3 CONTACT RESISTANCE: 10mΩ MAX.
- 2.4 INSULATION RESISTANCE: 1000 mΩ Min
- 2.5 Operation Temperature:-40°C to +125°C
- 2.6 VOLTAGE RATING: 400V AC/DC;

3.SALT SPRAY TEST:

- 3.1 CONCENTRATION IS 5%, THE TEMPERATURE IS 35±2°C, TEST TIME 24H MIN,NO OXIDATION OR RUST

4.Max Processing Temp:265°C Seconds 40S

5.ORDER INFORMATION:

3500-1S XXX SN 112 E X X

Pin数: 002=1*02PIN ~ 012=1*12PIN
 端子电镀: SN=Tin
 塑胶高度: 112=11.20mm
 A=A KEY B=B KEY

Foles	Dimensions(mm)	
	A	B
02	3.50	8.00
03	7.00	11.50
04	10.50	15.00
05	14.00	18.50
06	17.50	22.00
07	21.00	25.50
08	24.50	29.00
12	38.50	43.00

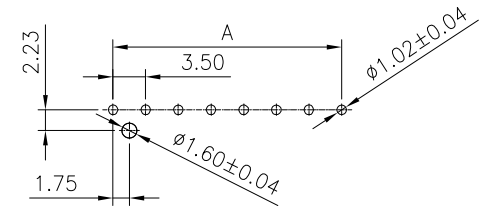
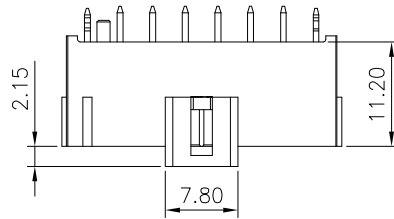

PCB LAYOUT

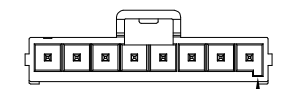
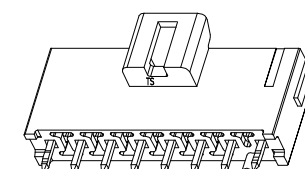
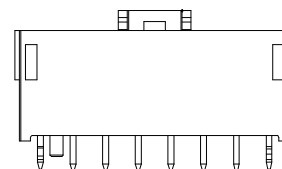
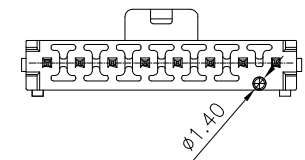
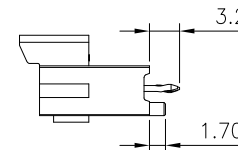
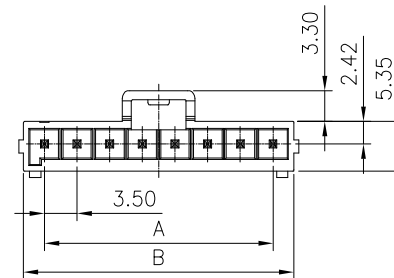

B KEY

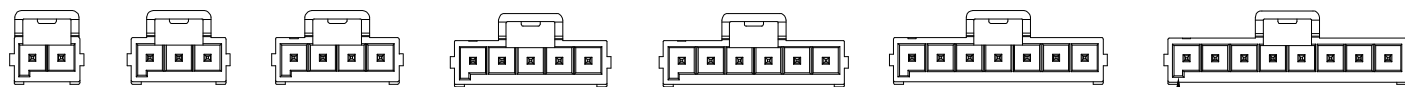

A KEY

REV	DATE	MODIFICATION DESCRIPTION	CHANGE	APPROVE	DIM.	TOL	UNIT	mm	SCALE	1:1	PROJ.	SIZE	A4	PART NO.	3500-1SXXXSX112EXX
AO		NEW			OPERATION		DRAW	WLY	2019.03.06	SOLEPIN 东莞市硕品电子有限公司 Professional connector manufacturer DONGGUAN SOLEPIN ELECTRONICS CO., LTD.					
					X.X ±0.40	DESIGN	Jensen	2019.03.06							
					X.XX ±0.25	CHECK	Jack	2019.03.06							
					X.XXX ±0.15	APPROVE	Andy	2019.03.06							
					Angle ±3°							SHEET	1/1	TITLE:	3.50mm CRIMP STYLE CONNECTORS
					DIM.	TOL	UNIT	mm	SCALE	1:1	PROJ.	PROJ.	DRAW NO.	SP-707	

客户图

NOTES:

.FINISH:

- 1.1 HOUSING: LCP BLACK 94V-0
- 1.2 CONTACT: H-HIGH CONDUCTIVE BRASS, GOLD (SEE P/N) PLATED IN CONTACT AREA, GOLD FLASH PLATED IN SOLDER AREA, 50u"MIN NICKEL UNDERPLATED OVERALL.

2. ELECTRICAL:

- 2.1 CURRENT RATING: 14A AC. DC
- 2.2 DIELECTRIC WITHSTANDING VOLTAGE: 1800V,AC/Minute
- 2.3 CONTACT RESISTANCE: 10mΩ MAX.
- 2.4 INSULATION RESISTANCE: 1000 mΩ Min
- 2.5 Operation Temperature: -40°C to +125°C
- 2.6 VOLTAGE RATING: 400V AC/DC;

3.SALT SPRAY TEST:

- 3.1 CONCENTRATION IS 5%, THE TEMPERATURE IS 35±2°C, TEST TIME 24H MIN, NO OXIDATION OR RUST

4.Max Processing Temp:265°C Seconds 40S

5.ORDER INFORMATION:

3500-1R XXX SN 112 E X X

Pin数 端子电镀: 塑胶高度: A=A KEY
 002=1*02PIN SN=Tin 112=11.20mm B=B KEY
 ~ 012=1*12PIN

Foles	Dimensions(mm)		
	A	B	C
02	3.50	8.00	
03	7.00	11.50	
04	10.50	15.00	7.00
05	14.00	18.50	10.50
06	17.50	22.00	14.00
07	21.00	25.50	17.50
08	24.50	29.00	21.00
12	38.50	43.00	34.00

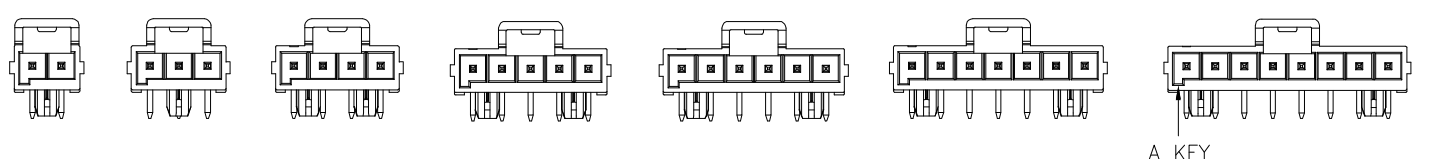
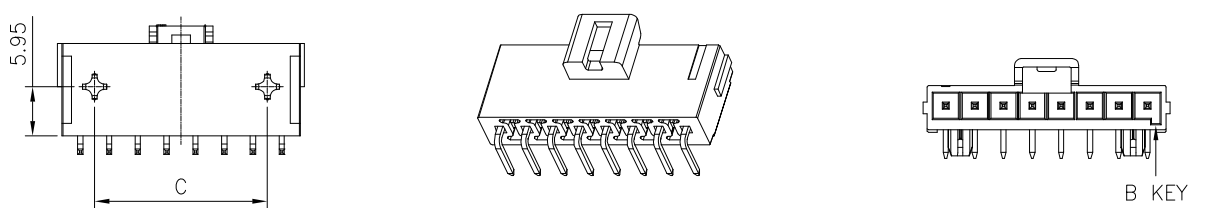
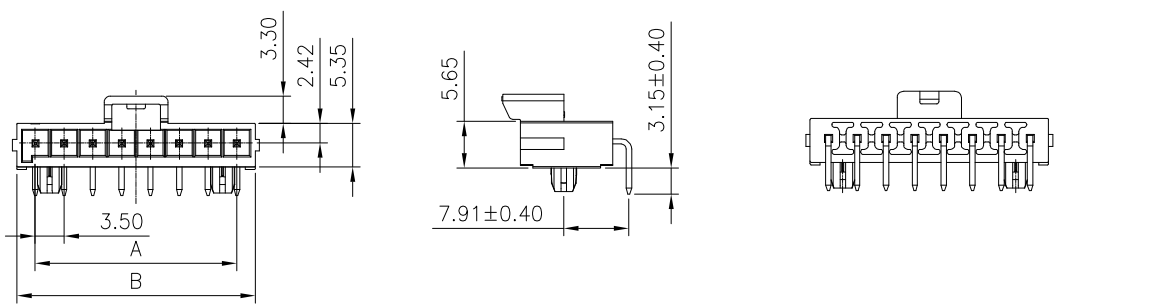
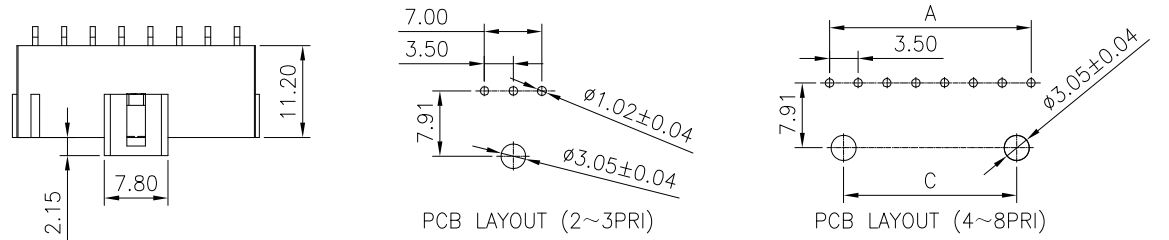

OPERATION		DRAW		WLY		2019.03.06		SOLEPIN 东莞市硕品电子有限公司			
X.X	±0.40	DESIGN	Jensen	2019.03.06		Professional connector manufacturer DONGGUAN SOLEPIN ELECTRONICS CO., LTD.		SIZE	A4	PART NO.	3500-1RXXXSX112EXX
X.XX	±0.25	CHECK	Jack	2019.03.06		SHEET	1/1	TITLE:	3.50mm CRIMP STYLE CONNECTORS		
X.XXX	±0.15	APPROVE	Andy	2019.03.06		PROJ.	SP-708	UNIT	mm	SCALE	1:1
Angle	±3°										
DIM.	TOL										

REV	DATE	MODIFICATION DESCRIPTION	CHANGE	APPROVE
AO		NEW		

客户图

NOTES:

.FINISH:

- 1.1 HOUSING: LCP BLACK 94V-0
- 1.2 CONTACT: H-HIGH CONDUCTIVE BRASS, GOLD (SEE P/N) PLATED IN CONTACT AREA, GOLD FLASH PLATED IN SOLDER AREA, 50u"MIN NICKEL UNDERPLATED OVERALL.

2. ELECTRICAL:

- 2.1 CURRENT RATING: 14A AC. DC
- 2.2 DIELECTRIC WITHSTANDING VOLTAGE: 1800V,AC/Minute
- 2.3 CONTACT RESISTANCE: 10mΩ MAX.
- 2.4 INSULATION RESISTANCE: 1000 mΩ Min
- 2.5 Operation Temperature: -40°C to +125°C
- 2.6 VOLTAGE RATING: 400V AC/DC;

3.SALT SPRAY TEST:

- 3.1 CONCENTRATION IS 5%, THE TEMPERATURE IS 35±2°C, TEST TIME 24H MIN, NO OXIDATION OR RUST

4.Max Processing Temp:265°C Seconds 40S

5.ORDER INFORMATION:

3501-S XXX SN 112 E X X

Pin数 端子电镀: 塑胶高度: A=A KEY
 002=2*01PIN SN=Tin 112=11.20mm B=B KEY
 ~ 024=2*12PIN

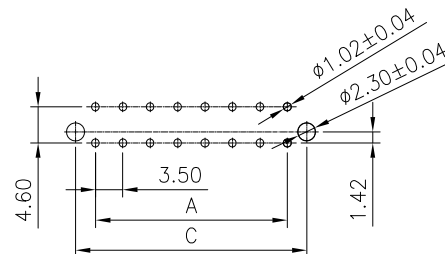
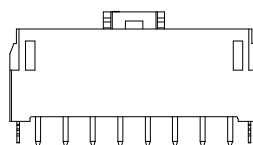
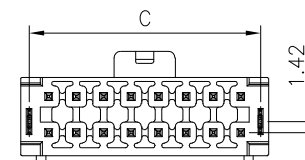
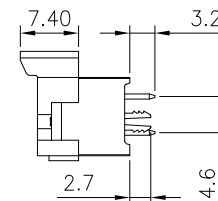
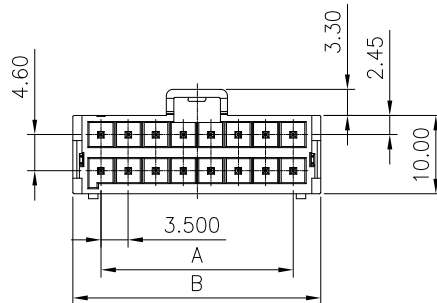
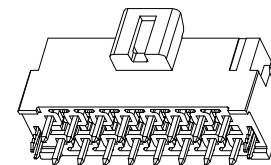
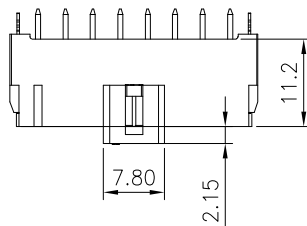

PCB Layout

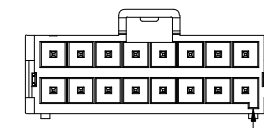

B KEY

Foles	Dimensions(mm)		
	A	B	C
004=2*02PIN	3.50	10.60	8.50
006=2*03PIN	7.00	14.10	12.00
008=2*04PIN	10.50	17.60	15.50
010=2*05PIN	14.00	21.10	19.00
012=2*06PIN	17.50	24.60	22.50
014=2*07PIN	21.00	28.10	26.00
016=2*08PIN	24.50	31.60	29.50
024=2*12PIN	38.50	45.60	43.50

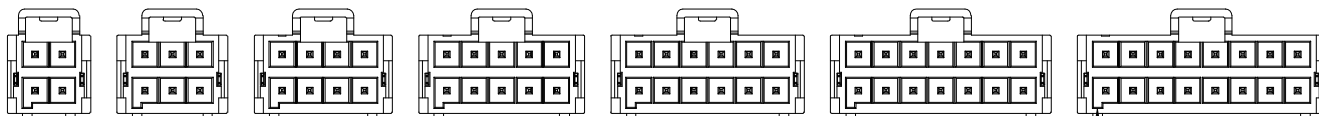

A KEY

					OPERATION	DRAW	WLY	2019.03.06	SOLEPIN 东莞市硕品电子有限公司 Professional connector manufacturer DONGGUAN SOLEPIN ELECTRONICS CO., LTD.				
					X.X ±0.40	DESIGN	Jensen	2019.03.06					
					X.XX ±0.25	CHECK	Jack	2019.03.06	SIZE	A4	PART NO.	3501-SXXXSX112EXX	
AO					X.XXX ±0.15	APPROVE	Andy	2019.03.06	SHEET	1/1	TITLE:	3.50mm CRIMP STYLE CONNECTORS	
REV	DATE	MODIFICATION DESCRIPTION	CHANGE	APPROVE	Angle ±3°	UNIT	mm	SCALE	1:1	PROJ.	DRAW NO.	SP-709	
					DIM. TOL								

客户图

NOTES:

.FINISH:

- 1.1 HOUSING: LCP BLACK 94V-0
- 1.2 CONTACT: H-HIGH CONDUCTIVE BRASS, GOLD (SEE P/N) PLATED IN CONTACT AREA, GOLD FLASH PLATED IN SOLDER AREA, 50u"MIN NICKEL UNDERPLATED OVERALL.

2. ELECTRICAL:

- 2.1 CURRENT RATING: 14A AC. DC
- 2.2 DIELECTRIC WITHSTANDING VOLTAGE: 1800V,AC/Minute
- 2.3 CONTACT RESISTANCE: 10mΩ MAX.
- 2.4 INSULATION RESISTANCE: 1000 mΩ Min
- 2.5 Operation Temperature: -40°C to +125°C
- 2.6 VOLTAGE RATING: 400V AC/DC;

3.SALT SPRAY TEST:

- 3.1 CONCENTRATION IS 5%, THE TEMPERATURE IS 35±2°C, TEST TIME 24H MIN, NO OXIDATION OR RUST

4.Max Processing Temp:265°C Seconds 40S

5.ORDER INFORMATION:

3501-1S XXX SN 112 E X X

Pin数 端子电镀: 塑胶高度: A=A KEY
 002=2*01PIN SN=TiN 112=11.20mm B=B KEY
 ~ ~ ~ ~
 024=2*12PIN

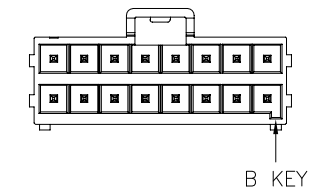
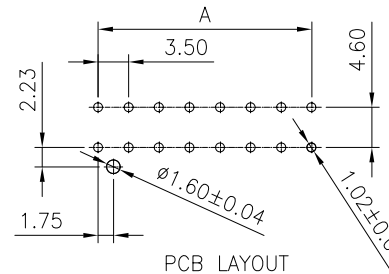
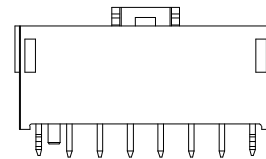
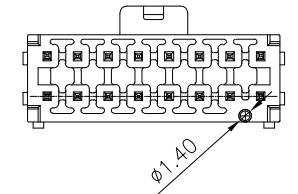
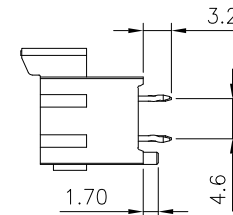
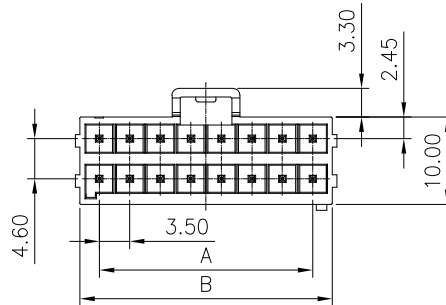
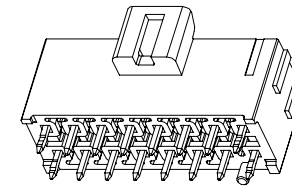
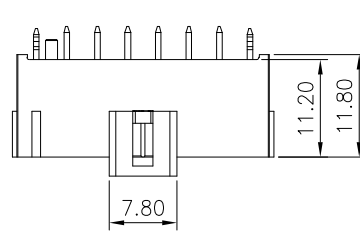

Foles	Dimensions(mm)	
	A	B
004=2*02PIN	3.50	8.00
006=2*03PIN	7.00	11.50
008=2*04PIN	10.50	15.00
010=2*05PIN	14.00	18.50
012=2*06PIN	17.50	22.00
014=2*07PIN	21.00	25.50
016=2*08PIN	24.50	29.00
024=2*12PIN	38.50	43.00

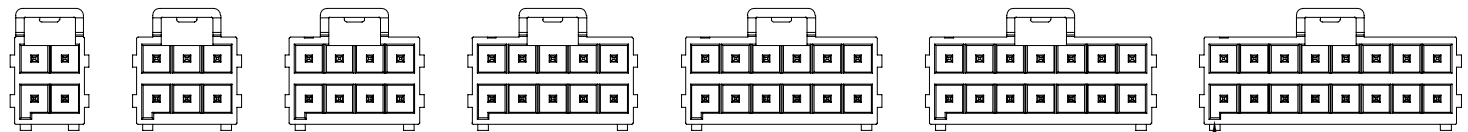

A KEY

REV	DATE	MODIFICATION DESCRIPTION	CHANGE	APPROVE	OPERATION		DRAW		WLY	2019.03.06	SOLEPIN 东莞市硕品电子有限公司		
					DIM.	TOL	DESIGN	Jensen			2019.03.06	Professional connector manufacturer DONGGUAN SOLEPIN ELECTRONICS CO., LTD.	
AO		NEW			X.X	±0.40	CHECK	Jack	2019.03.06	SIZE	A4	PART NO.	3501-1SXXXSX112EXX
					X.XX	±0.25	APPROVE	Andy	2019.03.06	SHEET	1/1	TITLE:	3.50mm CRIMP STYLE CONNECTORS
					Angle	±3°	UNIT	mm	SCALE	1:1	PROJ.	DRAW NO.	SP-710

客户图

NOTES:

.FINISH:

- 1.1 HOUSING: LCP BLACK 94V-0
- 1.2 CONTACT: H-HIGH CONDUCTIVE BRASS, GOLD (SEE P/N) PLATED IN CONTACT AREA, GOLD FLASH PLATED IN SOLDER AREA, 50u"MIN NICKEL UNDERPLATED OVERALL.

2. ELECTRICAL:

- 2.1 CURRENT RATING: 14A AC. DC
- 2.2 DIELECTRIC WITHSTANDING VOLTAGE: 1800V,AC/Minute
- 2.3 CONTACT RESISTANCE: 10mΩ MAX.
- 2.4 INSULATION RESISTANCE: 1000 mΩ Min
- 2.5 Operation Temperature: -40°C to +125°C
- 2.6 VOLTAGE RATING: 400V AC/DC;

3.SALT SPRAY TEST:

- 3.1 CONCENTRATION IS 5%, THE TEMPERATURE IS 35±2°C, TEST TIME 24H MIN, NO OXIDATION OR RUST

4.Max Processing Temp:265°C Seconds 40S

5.ORDER INFORMATION:

3501-R XXX SN 112 E X X

Pin数 端子电镀: 塑胶高度: A=A KEY
 002=2*01PIN SN=TiN 112=11.20mm B=B KEY
 ~ 024=2*12PIN

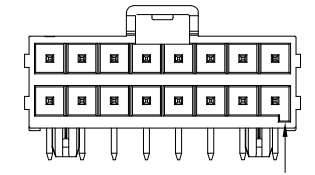
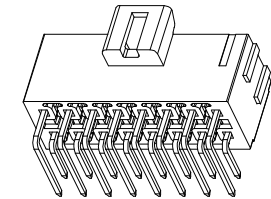
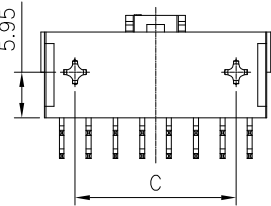
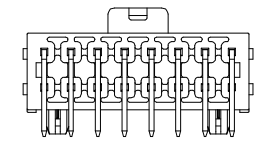
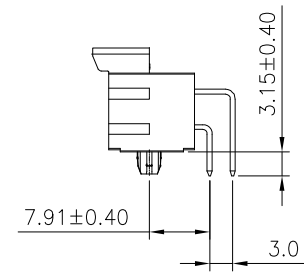
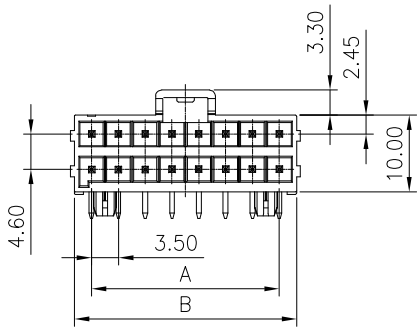
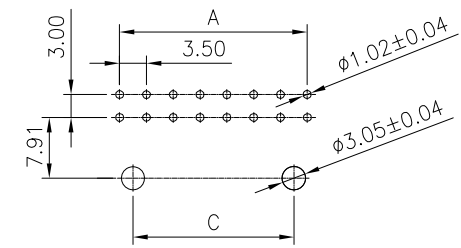
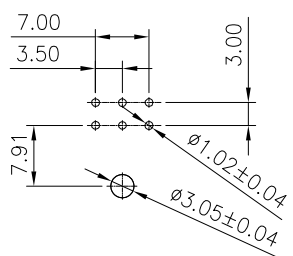
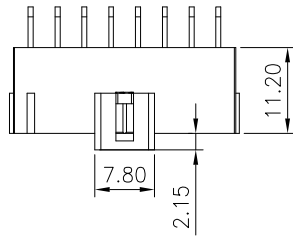

Foles	Dimensions(mm)		
	A	B	C
004=2*02PIN	3.50	8.00	
006=2*03PIN	7.00	11.50	
008=2*04PIN	10.50	15.00	7.00
010=2*05PIN	14.00	18.50	10.50
012=2*06PIN	17.50	22.00	14.00
014=2*07PIN	21.00	25.50	17.50
016=2*08PIN	24.50	29.00	21.00
024=2*12PIN	38.50	43.00	34.00

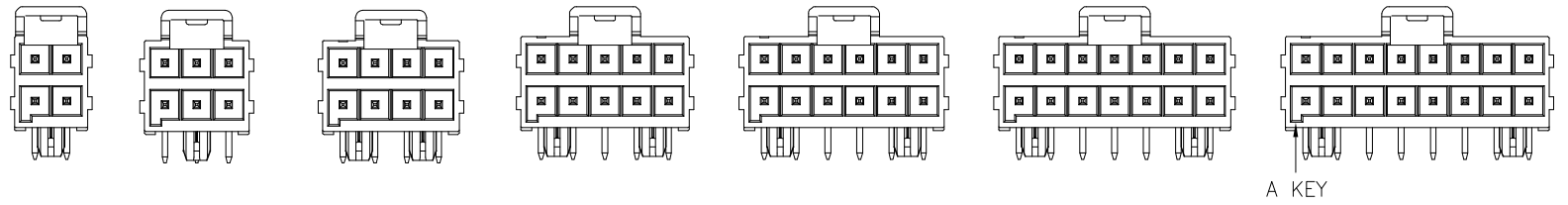

REV	DATE	MODIFICATION DESCRIPTION	CHANGE	APPROVE	OPERATION	DRAW	WLY	2019.03.06					
					X.X ±0.40	DESIGN	Jensen	2019.03.06					
					X.XX ±0.25	CHECK	Jack	2019.03.06					
					X.XXX ±0.15	APPROVE	Andy	2019.03.06					
					Angle ±3°								
					DIM. TOL	UNIT	mm	SCALE	1:1				

SOLEPIN 东莞市硕品电子有限公司
 Professional connector manufacturer DONGGUAN SOLEPIN ELECTRONICS CO., LTD.

SIZE A4 PART NO. 3501-RXXXSX112EXX
 SHEET 1/1 TITLE: 3.50mm CRIMP STYLE CONNECTORS
 PROJ. DRAW NO. SP-711

NEW

AO

客户图

NOTES:

1. FINISH:
 - 1.1 TERMINALS: High Conductivity Copper
 - 1.2 USE WITH: 350X-H HOUSING;
2. ELECTRICAL:
 - 2.1 VOLTAGE RATING: 400V AC/DC;
 - 2.2 CURRENT RATING: 14A AC/DC;
 - 2.3 DIELECTRIC WITHSTANDING VOLTAGE: 1800V AC/MINUTE.
 - 2.4 CONTACT RESISTANCE: 10mΩ MAX.
 - 2.5 INSULATION RESISTANCE: 1000MΩ MIN.
 - 2.6 OPERATION TEMPERATURE: -40°C TO +105°C.

3.ORDER INFORMATION:

3500 -T G SN XX

材料规格: 电镀规格: 流水码:
 G=高导铜 SN=Tin Plating 01=高脚 (High Lever)
 02=低脚 (Low Lever)

Part No.	Wire range	A	B	C	D
3500-TGSN01	#20-#22	2.20	2.20	2.10	2.33
3500-TGSN02	#16-#18	2.80	2.80	2.63	2.90

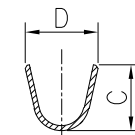
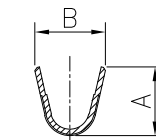
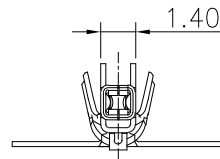
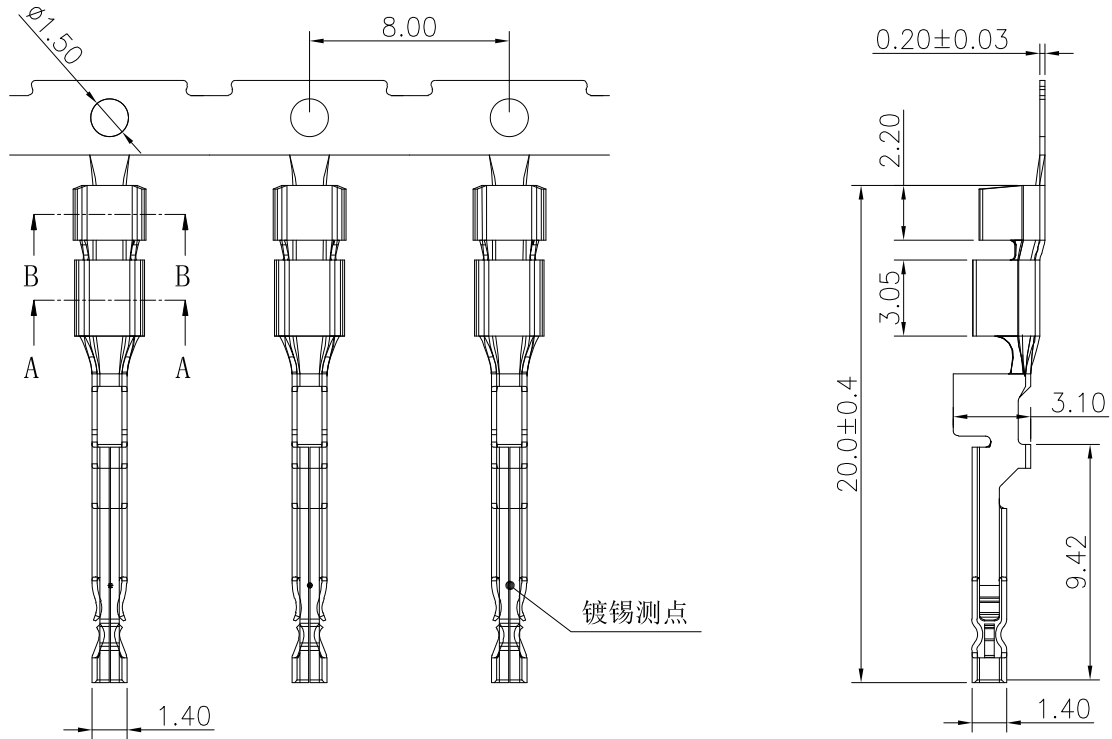

剖面 A-A

剖面 B-B

REV		DATE	MODIFICATION DESCRIPTION	CHANGE	APPROVE	OPERATION		DRAW		WLY	2020.11.20			
AO			NEW			X.X	±0.40	DESIGN	Jensen		2020.11.20			
						X.XX	±0.25	CHECK	Jack		2020.11.20			
						X.XXX	±0.15	APPROVE	Andy		2020.11.20			
						Angle	±3°	UNIT	mm	SCALE	1:1			
						DIM.	TOL			PROJ.	⌀	DRAW NO.	SP-712	

SOLEPIN 东莞市硕品电子有限公司
 Professional connector manufacturer DONGGUAN SOLEPIN ELECTRONICS CO., LTD.

SIZE A4 PART NO. 3500-TGSNXX

SHEET 1/1 TITLE: 3.50 CRIMP STYLE CONNECTORS

客户图

NOTES:

1. FINISH:

- 1.1 MATERIAL: PA66 UL 94V-0.
- 1.2 ACCEPTS 63K2T TERMINAL.
- 1.3 MATES WITH 63K2-WO

2. ELECTRICAL:

- 2.1 VOLTAGE RATING: 400V AC/DC;
- 2.2 CURRENT RATING: 14A AC/DC;
- 2.3 WITHSTANDING VOLTAGE: 1800V AC/MINUTE.
- 2.4 CONTACT RESISTANCE: 10mΩ MAX.
- 2.5 INSULATION RESISTANCE: 1000MΩ MIN.
- 2.6 OPERATION TEMPERATURE: -40°C TO +105°C.

3. ORDER INFORMATION:

⊕ 3500-H O XX N A

H=Housing
 O=One row
 Pin数码:
 002=02PIN
 ~
 012=12PIN

A=A KEY
 B=B KEY
 N=NATURAL
 B=BLACK

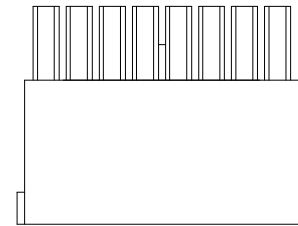
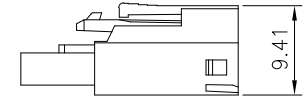
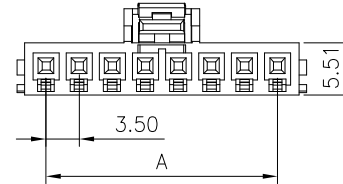
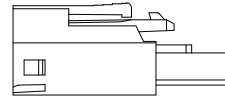
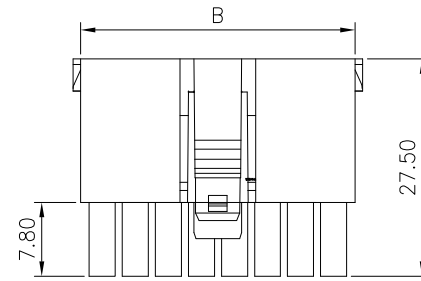

Poles	Dimensions(mm)	
	A	B
02	3.50	8.00
03	7.00	11.50
04	10.50	15.00
05	14.00	18.50
06	17.50	22.00
07	21.00	25.50
08	24.50	29.00
12	38.50	43.00

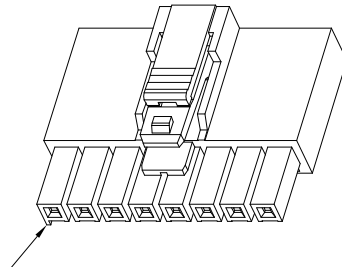

STANDARD, A KEY

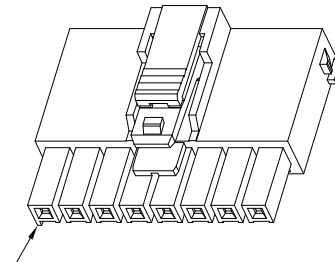

TPA TYPE, A KEY

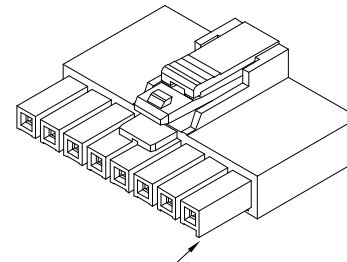

STANDARD, B KEY

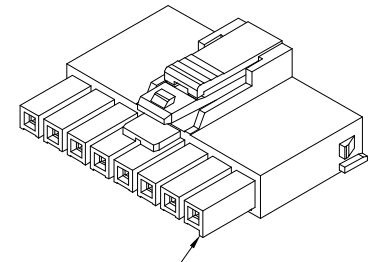

TPA TYPE, B KEY

					OPERATION	DRAW	WLY	2019.02.03	SOLEPIN 东莞市硕品电子有限公司 Professional connector manufacturer DONGGUAN SOLEPIN ELECTRONICS CO., LTD.				
					X.X ±0.40	DESIGN	Jensen	2019.02.03					
				WLY	X.XX ±0.25	CHECK	Jack	2019.02.03	SIZE	A4	PART NO.	3500-HOXXNA	
AO		NEW			X.XXX ±0.15	APPROVE	Andy	2019.02.03	SHEET	1/1	TITLE:	3.50mm CRIMP STYLE CONNECTORS	
REV	DATE	MODIFICATION DESCRIPTION	CHANGE	APPROVE	Angle ±3°	UNIT	mm	SCALE	1:1	PROJ.	⊕	DRAW NO.	SP-713
					DIM. TOL								

客户图

NOTES:

1. FINISH:

- 1.1 MATERIAL: PA66 UL 94V-0.
- 1.2 ACCEPTS 63K2T TERMINAL.
- 1.3 MATES WITH 350X

2. ELECTRICAL:

- 2.1 VOLTAGE RATING: 400V AC/DC;
- 2.2 CURRENT RATING: 14A AC/DC;
- 2.3 WITHSTANDING VOLTAGE: 1800V AC/MINUTE.
- 2.4 CONTACT RESISTANCE: 10mΩ MAX.
- 2.5 INSULATION RESISTANCE: 1000MΩ MIN.
- 2.6 OPERATION TEMPERATURE: -40°C TO +105°C.

3. ORDER INFORMATION:

④ 3501-H D XX N A

- H=Housing
- D=Double row
- Pin 数码: ~
- 004=2*02PIN
- 024=2*12PIN
- A=A KEY
- B=B KEY
- N=NATURAL
- B=BLACK

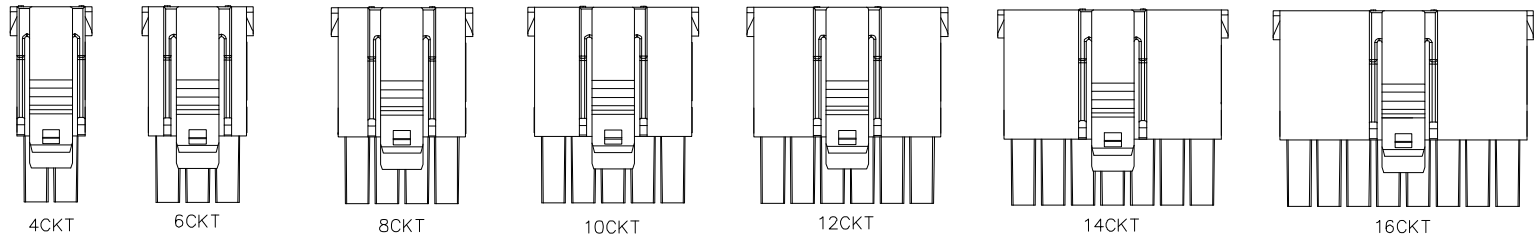
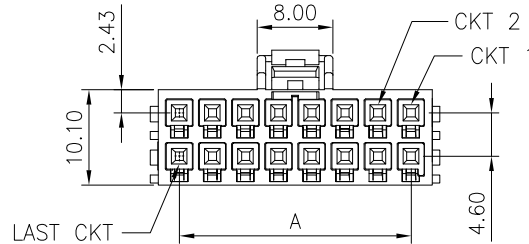
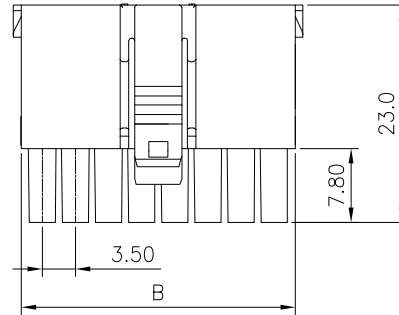
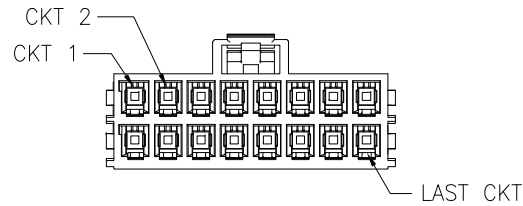

Poles	Dimensions(mm)	
	A	B
004=2*02PIN	3.50	8.00
006=2*03PIN	7.00	11.50
008=2*04PIN	10.50	15.00
010=2*05PIN	14.00	18.50
012=2*06PIN	17.50	22.00
014=2*07PIN	21.00	25.50
016=2*08PIN	24.50	29.00
024=2*12PIN	38.50	43.00

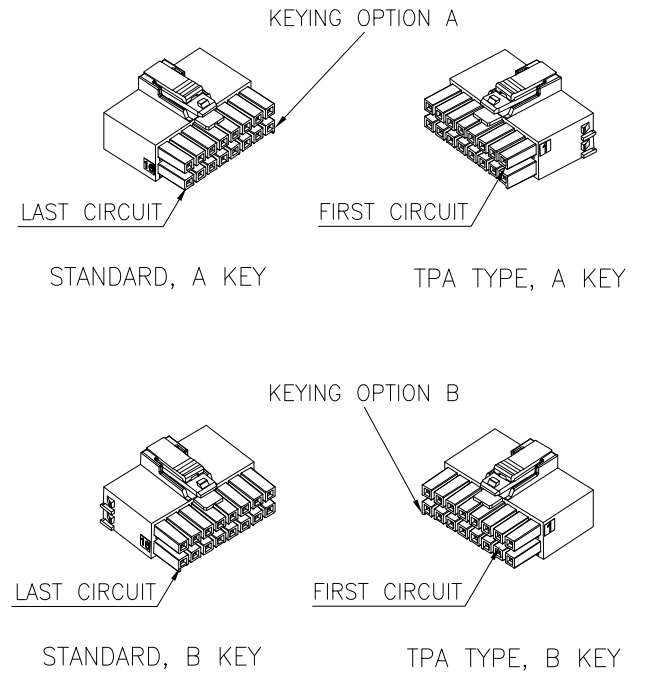

REV	DATE	MODIFICATION DESCRIPTION	CHANGE	APPROVE	OPERATION		DRAW		WLY		SOLEPIN 东莞市硕品电子有限公司			
					DIM.	TOL	DESIGN	CHECK	APPROVE	UNIT	mm	SCALE	1:1	PROJ.
AO		NEW			X.X	±0.40	WLY	Jensen	2019.03.02	Professional connector manufacturer DONGGUAN SOLEPIN ELECTRONICS CO., LTD.				
					X.XX	±0.25		Jack	2019.03.02	SHEET	1/1	TITLE:	3.50mm CRIMP STYLE CONNECTORS	
					X.XXX	±0.15		Andy	2019.03.02	PROJ.	⌀	DRAW NO.	SP-715	
					Angle	±3°								

客户图

NOTES:

1. FINISH:
 - 1.1 MATERIAL: PA66 UL 94V-0.
 - 1.2 MATES WITH 350X-H
2. ELECTRICAL:
 - 2.1 VOLTAGE RATING: 400V AC/DC;
 - 2.2 CURRENT RATING: 14A AC/DC;
 - 2.3 WITHSTANDING VOLTAGE: 1800V AC/MINUTE.
 - 2.4 CONTACT RESISTANCE: 10mΩ MAX.
 - 2.5 INSULATION RESISTANCE: 1000MΩ MIN.
 - 2.6 OPERATION TEMPERATURE: -40°C TO +105°C.
3. ORDER INFORMATION:

3500-S XX X

Pin数码: 颜色:
 02=2PIN N=Natural
 ~ B=Black
 12=12PIN

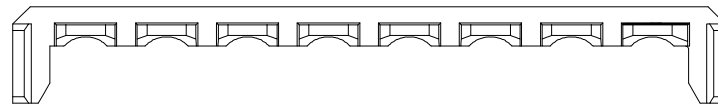
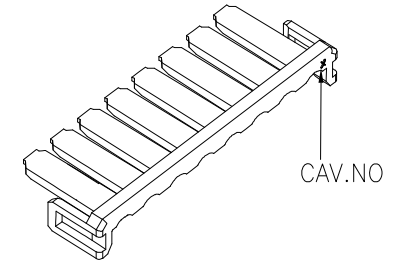
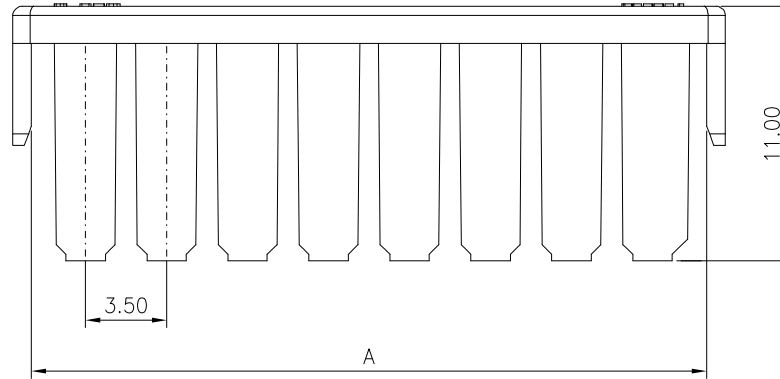

Poles	Dimensions(mm)	
	A	
02	8.20	
03	11.70	
04	15.20	
05	18.70	
06	22.20	
07	25.70	
08	29.20	
12	43.20	

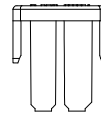

2P

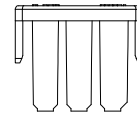

3P

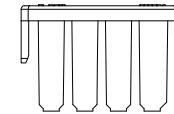

4P

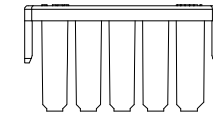

5P

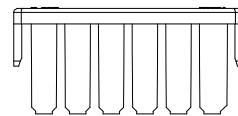

6P

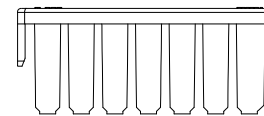

7P

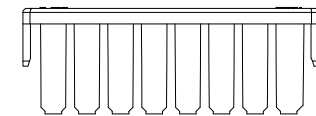

8P

						OPERATION	DRAW	WLY	2019.02.03	SOLEPIN 东莞市硕品电子有限公司 Professional connector manufacturer DONGGUAN SOLEPIN ELECTRONICS CO., LTD.			
						X.X ±0.40	DESIGN	Jensen	2019.02.03				
						X.XX ±0.25	CHECK	Jack	2019.02.03	SIZE	A4	PART NO.	3500-SXXX
AO						X.XXX ±0.15	APPROVE	Andy	2019.02.03	SHEET	1/1	TITLE:	3.50mm CRIMP STYLE CONNECTORS
REV	DATE	MODIFICATION DESCRIPTION	CHANGE	APPROVE		Angle ±3°	UNIT	mm	SCALE	1:1	PROJ.	DRAW NO.	SP-714
						DIM. TOL							