

# 客户图

## NOTES:

1. MATERIAL:
  - 1.1 HOUSING: Polyester(PA9T),UL94 V-0
  - 1.2 CONTACT: COPPER ALLOY, GOLD (SEE P/N) PLATED IN CONTACT AREA, GOLD FLASH PLATED IN SOLDER AREA, 50u"MIN NICKEL UNDERPLATED OVERALL.
2. ELECTRICAL:
  - 2.1 CURRENT RATING: 3.0 AMP,AC/DC
  - 2.2 DIELECTRIC WITHSTANDING VOLTAGE: 125V,AC/Minute
  - 2.3 CONTACT RESISTANCE: 100mΩ MAX.
  - 2.4 INSULATION RESISTANCE: 1000 mΩ Min
  - 2.5 Operation Temperature:-55°C to +150°C
3. SALT SPRAY TEST:
  - 3.1 CONCENTRATION IS 5%, THE TEMPERATURE IS 35±2°C, TEST TIME 8H MIN,NO OXIDATION OR RUST
4. Max Processing Temp:265°C Seconds 40S
5. ORDER INFORMATION:

61F8-J-200-XX-228-C 01

Pin数码 SEE TABLE	端子电镀: S0=Gold Tin S1=1u" Gold/Tin S2=3u" Gold/Tin S3=5u" Gold/Tin S4=10u" Gold/Tin S5=15u" Gold/Tin S6=30u" Gold/Tin	塑胶高度: 228=22.89mm	流水码: 01-99 包装方式: R=REEL C=TRAY
--------------------	---	----------------------	--

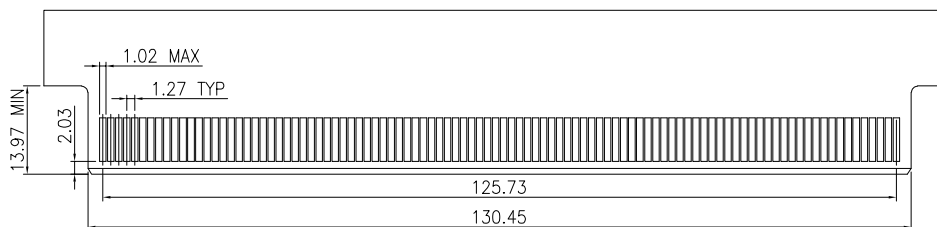
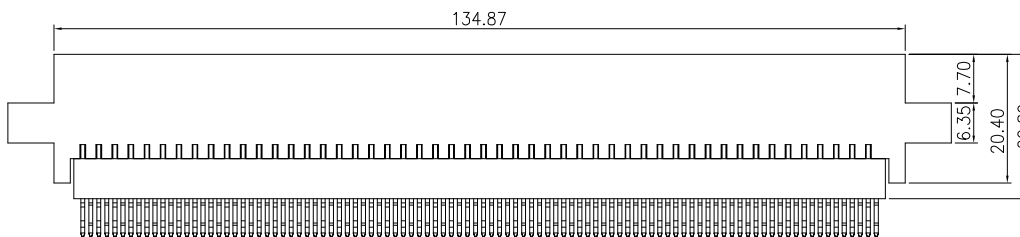
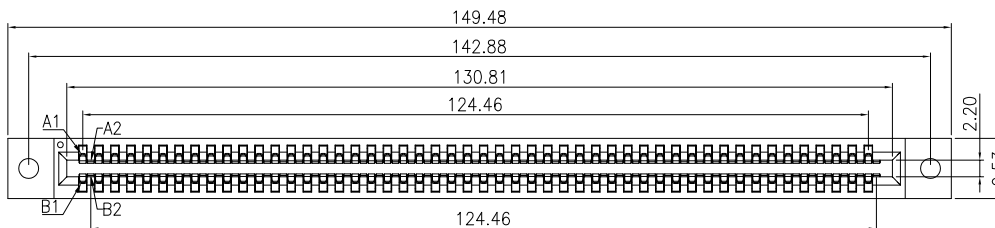
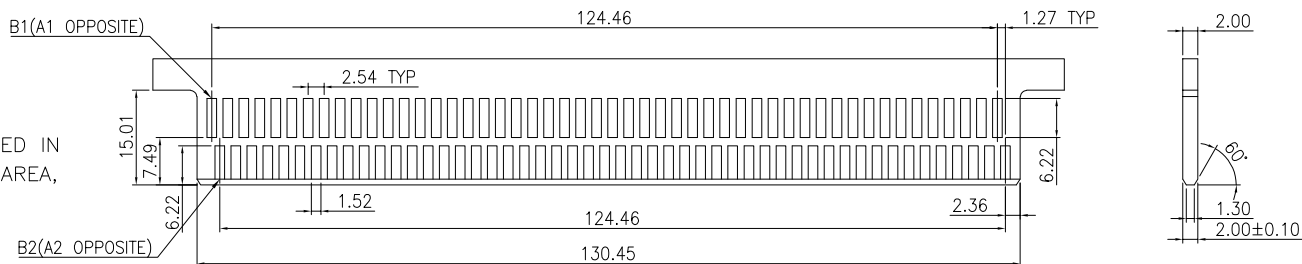
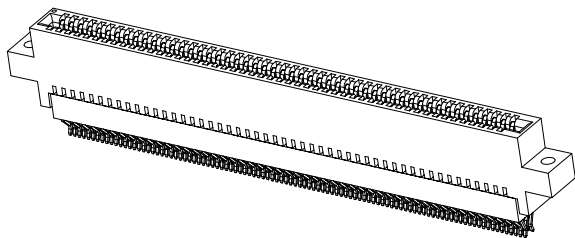

RECOMMENDED PCB LAYOUT(TOP SIDE)  
PCB BOARD TOLERANCE±0.05

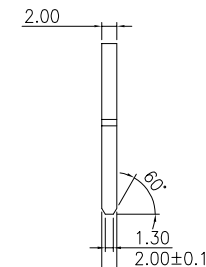
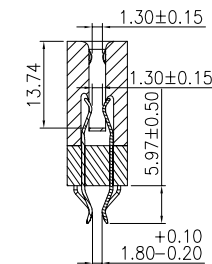
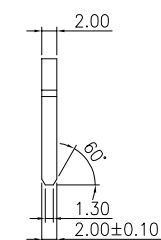

					OPERATION	DRAW	Mr.Zeng	2024.05.07	<b>SOLEPIN</b> 东莞市硕品电子有限公司 PROFESSIONAL CONNECTOR DONGGUAN SOLEPIN ELECTRONICS CO., LTD.			
					X.X ±0.40	DESIGN	Jensen	2024.05.07				
					X.XX ±0.25	CHECK	Jack	2024.05.07	SIZE	A4	PART NO.	61F8-J-200-XX-228-C 01
					X.XXX ±0.15	APPROVE	Andy	2024.05.07	SHEET	1/1	TITLE:	61F8_1.27mm 金手指 夹板式 带耳朵
AO					Angle ±3°	UNIT	mm	SCALE	1:1	PROJ.	DRAW NO.	SP-1561
REV	DATE	MODIFICATION	DESCRIPTION	CHANGE	APPROVE	DIM.	TOL					

# 客户图

## NOTES:

1. MATERIAL:
  - 1.1 HOUSING: Polyester(PA9T),UL94 V-0
  - 1.2 CONTACT: COPPER ALLOY, GOLD (SEE P/N) PLATED IN CONTACT AREA, GOLD FLASH PLATED IN SOLDER AREA, 50u"MIN NICKEL UNDERPLATED OVERALL.
2. ELECTRICAL:
  - 2.1 CURRENT RATING: 3.0 AMP,AC/DC
  - 2.2 DIELECTRIC WITHSTANDING VOLTAGE: 125V,AC/Minute
  - 2.3 CONTACT RESISTANCE: 100mΩ MAX.
  - 2.4 INSULATION RESISTANCE: 1000 mΩ Min
  - 2.5 Operation Temperature:-55°C to +150°C
3. SALT SPRAY TEST:
  - 3.1 CONCENTRATION IS 5%, THE TEMPERATURE IS 35±2°C, TEST TIME 8H MIN,NO OXIDATION OR RUST
4. Max Processing Temp:265°C Seconds 40S
5. ORDER INFORMATION:

61F8-SX-200-SX-243-C 01

Pin 数码  
SEE TABLE

端子电镀:  
S0=Gold Tin  
S1=1u" Gold/Tin  
S2=3u" Gold/Tin  
S3=5u" Gold/Tin  
S4=10u" Gold/Tin  
S5=15u" Gold/Tin  
S6=30u" Gold/Tin

塑胶高度:  
243=24.36mm

流水码:  
01-99

包装方式:  
R=REEL  
C=TRAY

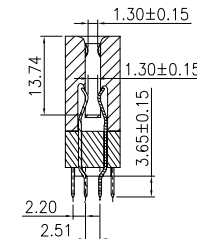
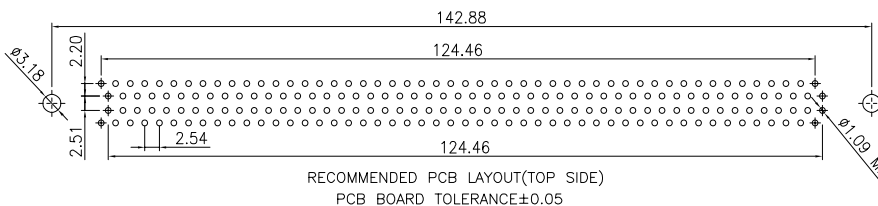
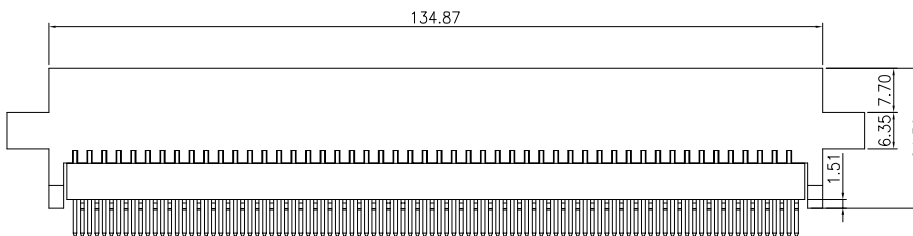
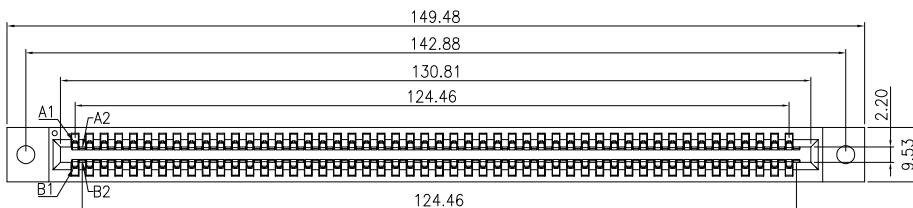
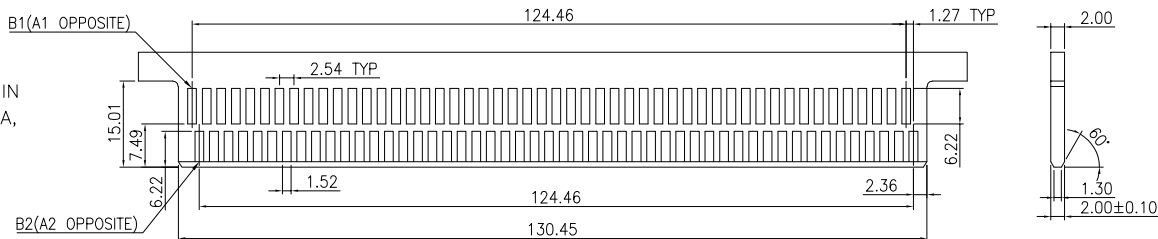
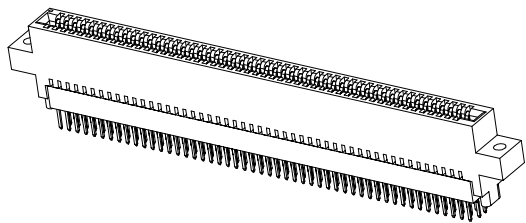

61F8-S1-200-SX-243-C 01

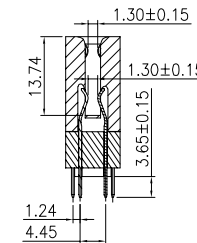

61F8-S2-200-SX-243-C 01

OPERATION		DRAW	Mr.Zeng	2024.05.07
X.X	±0.40	DESIGN	Jensen	2024.05.07
X.XX	±0.25	CHECK	Jack	2024.05.07
X.XXX	±0.15	APPROVE	Andy	2024.05.07
Angle	±3°	UNIT	mm	SCALE 1:1
DIM.	TOL	PROJ.	φ	

**SOLEPIN** 东莞市硕品电子有限公司  
PROFESSIONAL CONNECTOR DONGGUAN SOLEPIN ELECTRONICS CO., LTD.

AO	NEW			
REV	DATE	MODIFICATION DESCRIPTION	CHANGE	APPROVE

SIZE	A4	PART NO.	61F8-SX-200-SX-243-C 01
SHEET	1/1	TITLE:	61F8 1.27mm 金手指 DIP 180° 带耳朵
PROJ.	φ	DRAW NO.	SP-1559

# 客户图

## NOTES:

1. MATERIAL:
  - 1.1 HOUSING: Polyester(PA9T),UL94 V-0
  - 1.2 CONTACT: COPPER ALLOY, GOLD (SEE P/N) PLATED IN CONTACT AREA, GOLD FLASH PLATED IN SOLDER AREA, 50u"MIN NICKEL UNDERPLATED OVERALL.
2. ELECTRICAL:
  - 2.1 CURRENT RATING: 3.0 AMP,AC/DC
  - 2.2 DIELECTRIC WITHSTANDING VOLTAGE: 500V,AC/Minute
  - 2.3 CONTACT RESISTANCE: 30mΩ MAX.
  - 2.4 INSULATION RESISTANCE: 5000 mΩ Min
  - 2.5 Operating Voltage: 225 VAC
  - 2.5 Operation Temperature:-55°C to +150°C
3. SALT SPRAY TEST:
  - 3.1 CONCENTRATION IS 5%, THE TEMPERATURE IS 35±2°C, TEST TIME 8H MIN,NO OXIDATION OR RUST
4. Max Processing Temp:265°C Seconds 40S
5. ORDER INFORMATION:

61F8W-J-200-XX-228-C 01

Pin数码  
SEE TABLE

端子电镀:

- S0=Gold Tin
- S1=1u" Gold/Tin
- S2=3u" Gold/Tin
- S3=5u" Gold/Tin
- S4=10u" Gold/Tin
- S5=15u" Gold/Tin
- S6=30u" Gold/Tin

塑胶高度:

228=22.89mm

包装方式:

- R=REEL
- C=TRAY

流水码:  
01-99

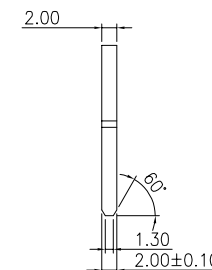
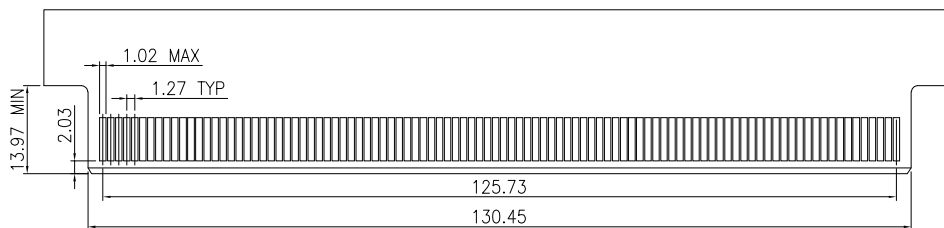
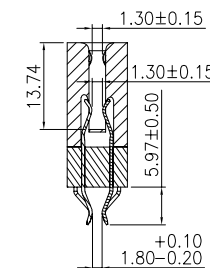
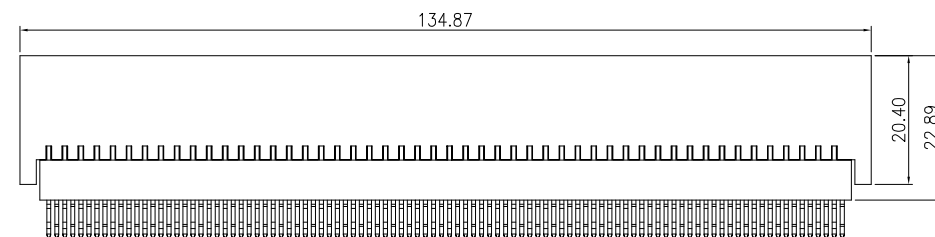
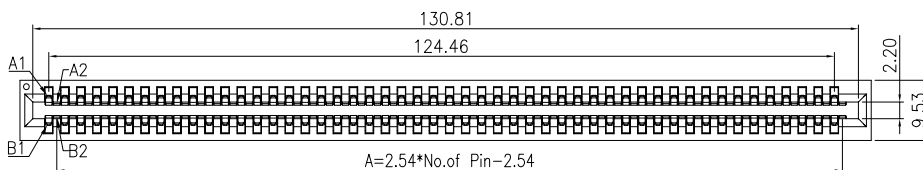
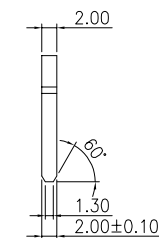
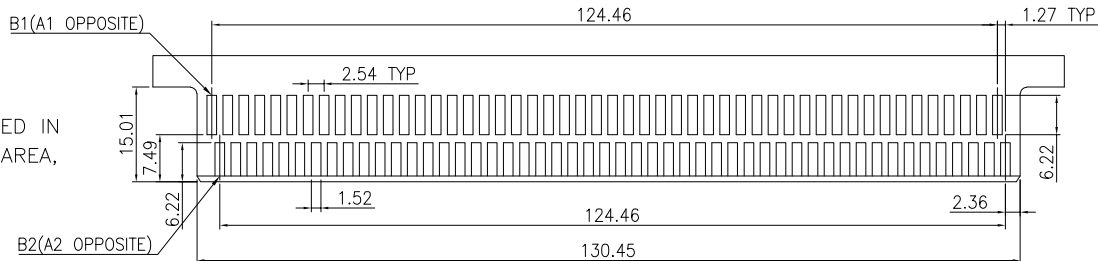
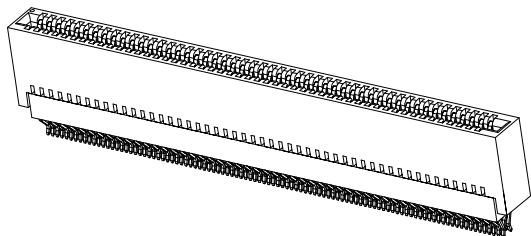

RECOMMENDED PCB LAYOUT(TOP SIDE)  
PCB BOARD TOLERANCE±0.05

OPERATION		DRAW	Mr.Zeng	2024.05.07
X.X	±0.40	DESIGN	Jensen	2024.05.07
X.XX	±0.25	CHECK	Jack	2024.05.07
X.XXX	±0.15	APPROVE	Andy	2024.05.07
Angle	±3'	UNIT	mm	SCALE
DIM.	TOL	UNIT	mm	SCALE
				1:1

SOLEPIN 东莞市硕品电子有限公司				
PROFESSIONAL CONNECTOR DONGGUAN SOLEPIN ELECTRONICS CO., LTD.				
SIZE	A4	PART NO.	61F8W-J-200-XX-228-C 01	
SHEET	1/1	TITLE:	61F8_1.27mm 金手指 夹板式 无耳朵	
PROJ.	☯	DRAW NO.	SP-1560	

REV	DATE	MODIFICATION DESCRIPTION	CHANGE	APPROVE
A0		NEW		

# 客户图

## NOTES:

### 1.MATERIAL:

- 1.1 HOUSING: Polyester(PA9T),UL94 V-0
- 1.2 CONTACT: COPPER ALLOY, GOLD (SEE P/N) PLATED IN CONTACT AREA, GOLD FLASH PLATED IN SOLDER AREA, 50u"MIN NICKEL UNDERPLATED OVERALL.

### 2. ELECTRICAL:

- 2.1 CURRENT RATING: 3.0 AMP,AC/DC
- 2.2 DIELECTRIC WITHSTANDING VOLTAGE: 500V,AC/Minute
- 2.3 CONTACT RESISTANCE: 30mΩ MAX.
- 2.4 INSULATION RESISTANCE: 5000 mΩ Min
- 2.5 Operating Voltage: 225 VAC
- 2.5 Operation Temperature:-55°C to +150°C

### 3.SALT SPRAY TEST:

- 3.1 CONCENTRATION IS 5%, THE TEMPERATURE IS 35±2°C, TEST TIME 8H MIN,NO OXIDATION OR RUST

### 4.Max Processing Temp:265°C Seconds 40S

### 5.ORDER INFORMATION:

61F8W-SX-200-SX-243-C 01

Pin 数码 SEE TABLE	端子电镀: S0=Gold Tin S1=1u" Gold/Tin S2=3u" Gold/Tin S3=5u" Gold/Tin S4=10u" Gold/Tin S5=15u" Gold/Tin S6=30u" Gold/Tin	塑胶高度: 243=24.36mm	流水码: 01-99	包装方式: R=REEL C=TRAY
---------------------	---	----------------------	---------------	---------------------------

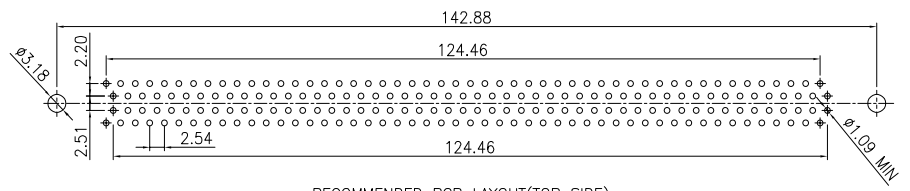
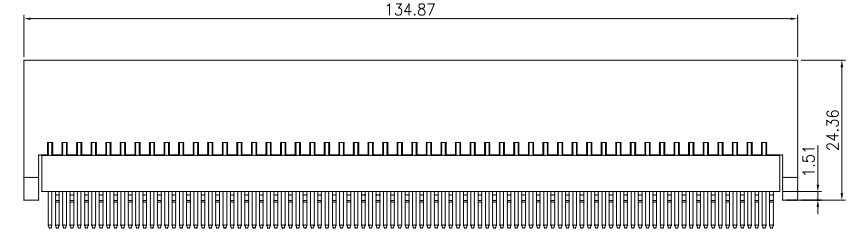
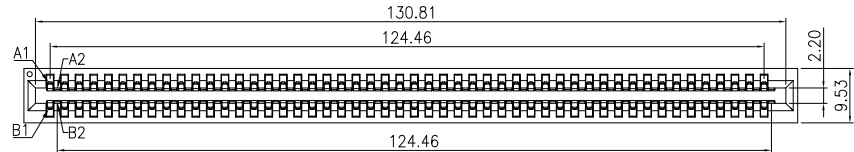
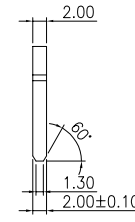
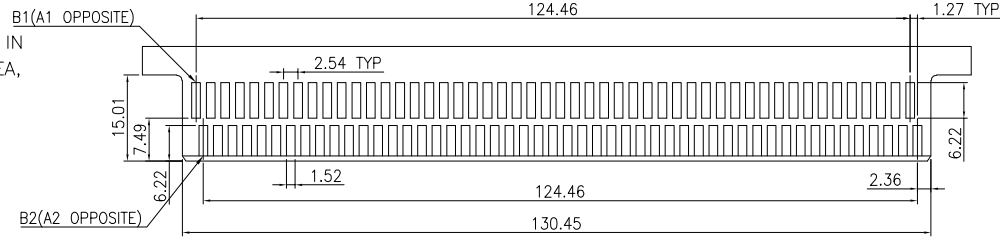
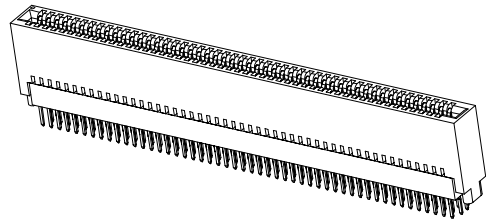

RECOMMENDED PCB LAYOUT(TOP SIDE)  
PCB BOARD TOLERANCE±0.05

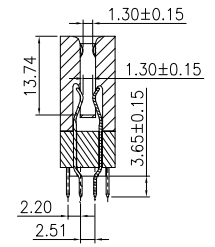

61F8W-S1-200-SX-243-C 01

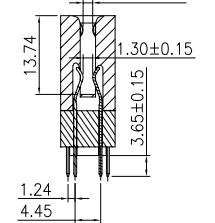

61F8W-S2-200-SX-243-C 01

						OPERATION	DRAW	Mr.Zeng	2024.05.07	<b>SOLEPIN 东莞市硕品电子有限公司</b> <b>PROFESSIONAL CONNECTOR DONGGUAN SOLEPIN ELECTRONICS CO., LTD.</b>			
						X.X ±0.40	DESIGN	Jensen	2024.05.07				
						X.XX ±0.25	CHECK	Jack	2024.05.07	SIZE	A4	PART NO.	61F8W-SX-200-SX-243-C 01
						X.XXX ±0.15	APPROVE	Andy	2024.05.07	SHEET	1/1	TITLE:	61F8 1.27mm 金手指 DIP 180° 无耳朵
AO			NEW			Angle ±3°				PROJ.	☉	DRAW NO.	SP-1558
REV	DATE		MODIFICATION DESCRIPTION	CHANGE	APPROVE	DIM. TOL	UNIT	mm	SCALE	1:1			